

FMC-420RW Single Action Call Points LSN improved

www.boschsecurity.com



BOSCH
Invented for life



- ▶ Alarm triggering by pressing the black marking or breaking the glass pane
- ▶ Protection against injury through foil-labeled glass pane
- ▶ LED display for triggered alarm or inspection evaluation
- ▶ Individual call point identification
- ▶ Call point query routines with evaluation and multiple transmission

FMC-420RW Single Action Call Points are used for manual triggering and can be employed in both the Local SecurityNetwork (LSN) and the LSN improved version.

Functions

Single action call points with glass pane:

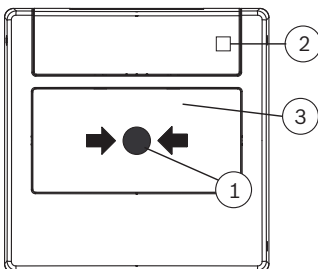

Pressing the black marking (1) breaks the glass pane (3), which triggers the alarm and causes the LED (2) to flash.

Single action call points can be reset with the test key and by replacing the glass pane (3). The LED display (2) goes dark.

Resettable single action call points:

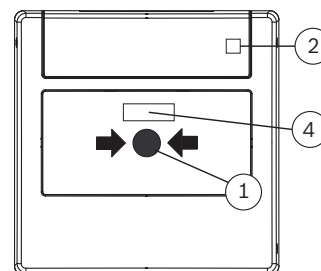

Pressing the black marking (1) triggers the alarm. The alarm status is indicated by the changed window color (4) and the flashing LED (2).

Single action call points can be reset using the test key. The LED (2) goes dark.

Individual call point identification

Neither single action call points with glass pane nor resettable single action call points are reset on the fire panel.

Individual call point identification with display of the call point address on the fire panel ensures the quick location of the triggered call point.

Certifications and approvals

Region	Regulatory compliance/quality marks	
Germany	VdS	G 207087 FMC-420RW
	VdS	G210017 FMC-420-RW-HSGRD/-HSRRD
Europe	CE	FMC-420RW-GSGBU/-GSRBU/-GSGYE/-GSRYE
	CE	FMC-420RW-GSGRD/-GSRRD/-GFGRD/-GFRRD
	CE	FMC-420RW-HSGRD/-HSRRD
	CPD	0786-CPD-20333 FMC-420RW
	CPD	0786-CPD-20942 FMC-420RW-HSGRD
	CPD	0786-CPD-20943 FMC-420RW-HSRRD
Ukraine	MOE	UA1.016.0091994-09 FMC-420RW

Installation/configuration notes

- Manual call points must be mounted visibly along escape and rescue routes (e.g. exits, passageways, stairwells) and be easily accessible.
- An installation height of 1400 mm ±200 mm (55 in. ±8 in.), measured from the middle of the manual call point to the floor, must be maintained.
- Manual call points must be sufficiently lit with daylight or another light source (including emergency lighting if present).
- The maximum number of LSN elements that can be connected depends on their current consumption from the LSN data line. The limit values should be taken from the product information supplied with the fire panel used.
- Standards, guidelines and planning recommendations regarding the installation location etc. should also be taken into consideration.
- The regulations of the local fire services must be observed.

Technical specifications

Electrical

	LSN current consumption (mA)	Operating voltage (VDC)
FMC-420RW-GSGRD Manual call point glass surface-mnt, red	0,26 mA	15 - 33 VDC
FMC-420RW-GSRRD Manual call point reset surface-mnt, red	0,26 mA	15 - 33 VDC

	LSN current consumption (mA)	Operating voltage (VDC)
FMC-420RW-GFGRD Manual call point glass flush-mount, red	0,26 mA	15 - 33 VDC

	LSN current consumption (mA)	Operating voltage (VDC)
FMC-420RW-GFRRD Manual call point reset flush-mount, red	0,26 mA	15 - 33 VDC

	LSN current consumption (mA)	Operating voltage (VDC)
FMC-420RW-GSGYE Manual call point, glass, yellow	0,26 mA	15 - 33 VDC

	LSN current consumption (mA)	Operating voltage (VDC)
FMC-420RW-GSRYE Manual call point, resettable, yellow	0,26 mA	15 - 33 VDC

Mechanical components

Dimensions (H x W x D)	
• FMC-420RW-GFGRD, FMC-420RW-GFRRD	107 mm x 107 mm x 38.5 mm (4.2 in. X 4.2 in. X 1.5 in.)
• FMC-420RW-GSGRD, FMC-420RW-GSGBU, FMC-420RW-GSGYE	87 mm x 87 mm x 56 mm (3.4 in. X 3.4 in. X 2.2 in.)
• FMC-420RW-GSRRD, FMC-420RW-GSRBU, FMC-420RW-GSRYE	87 mm x 87 mm x 56 mm (3.4 in. X 3.4 in. X 2.2 in.)
• FMC-420RW-HSGRD, FMC-420RW-HSRRD	108 mm x 108 mm x 66 mm (4.25 in. X 4.25 in. X 2.6 in.)
Housing material	Plastic, ASA
Colors	
• Red	RAL 3001
• Blue	RAL 5005
• Yellow	RAL 1003
• Red/white	RAL 3001 / RAL 9003

Environmental conditions

Protection category according to EN 60529	IP 54
Protection category according to EN 60529 for FMC-420RW-HSGRD FMC-420RW-HSRRD	IP 67
Permissible operating temperature	-25 °C to +70 °C
Permissible rel. humidity	< 96 %

Ordering information**FMC-420RW-GSGRD Manual call point glass surface-mount, red**

analog addressable manual call point with glass pane for indoor use, direct alarm triggering (type A), surface-mounted, red
Order number **FMC-420RW-GSGRD**

FMC-420RW-GSRRD Manual call point reset surface-mount, red

resettable analog addressable manual call point for indoor use, direct alarm triggering (type A), surface-mounted, red
Order number **FMC-420RW-GSRRD**

FMC-420RW-GFGRD Manual call point glass flush-mount, red

analog addressable manual call point with glass pane for indoor use, direct alarm triggering (type A), flush-mounted, red. In addition, you need to order FMC-BEZEL.
Order number **FMC-420RW-GFGRD**

FMC-420RW-GFRRD Manual call point reset flush-mount, red

resettable analog addressable manual call point for indoor use, direct alarm triggering (type A), flush-mounted, red. In addition, you need to order FMC-BEZEL.
Order number **FMC-420RW-GFRRD**

FMC-420RW-GSGYE Manual call point, glass, yellow
analog addressable manual call point with glass pane for indoor use, direct alarm triggering (type A), surface-mounted, yellow
Order number **FMC-420RW-GSGYE**

FMC-420RW-GSRYE Manual call point, resettable, yellow

resettable analog addressable manual call point for indoor use, direct alarm triggering (type A), surface-mounted, yellow
Order number **FMC-420RW-GSRYE**

FMC-420RW-GSGBU Manual call point, glass, blue
analog addressable manual call point with glass pane for indoor use, direct alarm triggering (type A), surface-mounted, blue
Order number **FMC-420RW-GSGBU**

FMC-420RW-GSRBU Manual call point, resettable, blue
resettable analog addressable manual call point for indoor use, direct alarm triggering (type A), surface-mounted, blue
Order number **FMC-420RW-GSRBU**

FMC-420RW-HSGRD Manual call point, outdoor, glass, red
analog addressable manual call point with glass pane for outdoor use, direct alarm triggering (type A), surface-mounted, red/ white
Order number **FMC-420RW-HSGRD**

FMC-420RW-HSRRD Manual call point outdoor resettable red
resettable analog addressable manual call point for outdoor use, direct alarm triggering (type A), surface-mounted, red/ white
Order number **FMC-420RW-HSRRD**

Accessories

FMC-BEZEL-RD Bezel for manual call point, red
Frame for the flush-mounted variant of the RW call points.
1 unit = 4 bezels
Order number **FMC-BEZEL-RD**

FMC-BEZEL-WH Bezel for manual call point, white
Frame for the flush-mounted variant of the RW call points.
1 unit = 4 bezels
Order number **FMC-BEZEL-WH**

FMC-SEAL-RW Seal for manual call point
Seal for clear hinged flap
1 unit = 100 seals
Order number **FMC-SEAL-RW**

FMC-SPACER-RWRD Spacer, red
For the flush-mounted variant of the RW call points. Its use increases the storage room for the cables.

1 unit = 5 spacers
Order number **FMC-SPACER-RWRD**

FMC-SPGL-RW Spare glass
Spare glasses for all RW call points.
1 unit = 5 spare glasses
Order number **FMC-SPGL-RW**

FMC-SIGN-RW Sign, out-of-order
Used instead of the glass pane when a call point is not ready for use.
1 unit = 5 signs
Order number **FMC-SIGN-RW**

FMC-KEY-RW Test key
The key can open, check, and reset manual call points.
1 unit = 1 key
Order number **FMC-KEY-RW**

FMC-FLAP-RW Flap, transparent
To protect against accidental triggering; with seal.
1 unit = 5 flaps
Order number **FMC-FLAP-RW**

Represented by:

Europe, Middle East, Africa:
Bosch Security Systems B.V.
P.O. Box 80002
5600 JB Eindhoven, The Netherlands
Phone: + 31 40 2577 284
emea.securitysystems@bosch.com
emea.boschsecurity.com

Germany:
Bosch Sicherheitssysteme GmbH
Robert-Bosch-Ring 5
85630 Grasbrunn
Germany
www.boschsecurity.com

North America:
Bosch Security Systems, Inc.
130 Perinton Parkway
Fairport, New York, 14450, USA
Phone: +1 800 289 0096
Fax: +1 585 223 9180
onlinehelp@us.bosch.com
www.boschsecurity.us

Asia-Pacific:
Robert Bosch (SEA) Pte Ltd, Security Systems
11 Bishan Street 21
Singapore 573943
Phone: +65 6571 2808
Fax: +65 6571 2699
apr.securitysystems@bosch.com
www.boschsecurity.asia